

This one time CloudCME set up gets you ready for all of the ACE activities at Children's of Alabama.

Step 1: Login to your Children's of Alabama CloudCME account and complete your profile.

Make sure to complete all items in red and provide your cell phone number in the Mobile phone box.

Step 2: Set up your phone for texting in activity attendance.

Tip: Add the number to your contacts as ACE

Step 3: Download the CloudCME app to easily complete evaluations on your phone while at the activity.

Organizational Code: **Childrensai**

Tip: When asked to log in make sure to slowly enter your login credentials for accuracy. ***
In order to receive ACE credits for attending an activity you must complete an evaluation***

Follow the instructions provided in this packet.
Set up time normally takes 10-15 minutes.

CloudCME Profile



Do you have an email address ending in @childrensal.org? Yes. You are an **Internal User**, follow the instructions for internal users to get logged into your Children's of Alabama CloudCME.

No. You are an **External User**, follow the instructions for external users to get logged into your Children's of Alabama CloudCME.

Internal Users COA

Step 1: Go to <https://Childrensal.cloud-cme.com>. Click "Sign In" in the upper left corner of the screen.

Children's of Alabama employees: please log in using your @childrensal.org and your CloudCME password.

Example: CHS123@childrensal.org & CloudCME password.

You can now move ahead to the Profile instructions.

External Users

Step 1: Go to <https://Childrensal.cloud-cme.com>. Click "Sign In" in the upper left corner of the screen.

UABMC: Please log in using your @uabmc.edu email and your CloudCME password.

Example: John.Smith@uabmc.edu

Please note: If you have a @uabmc.edu or @uab.edu email address you may already be in the system and only require a password set up. You can click 'Forgot Password' at the time of log in and if your email is in the system you will be sent a link to set up a new password.

For all other users: you will need to set up an account. You can continue to scroll down the screen and select the

A yellow rounded rectangular button with the text "Sign Up Now" in a bold, black, sans-serif font.

tab at the bottom of the page.

Logged in? You can now move ahead to the Profile instructions.

Once you have logged

A red button with white text that says "My CME".

in please go to the

tab located at the top of the screen.

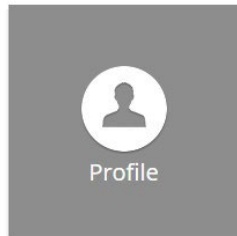

From there please
select

Make sure that you complete everything in **red**, **add your cell phone to the Mobile box** and



In order to text in your attendance, we will need your Mobile number added to the Mobile box.

Note: Only Physicians can claim AMA PRA Category 1 Credits

I am eligible for the following credit categories

AMA PRA Category 1 Credits™

Non-Physician Attendance

General Attendance

ABP MOC Part 2

Next Step: SMS Texting

SMS Texting

You can record your attendance directly after the meeting or up to 72 hours after the meeting.

You will need to know the **Event ID** for the activity/session and this will be provided to you either through an email, posted at the activity, located on the CloudCME page prior to the activity starting or a combination of these.

TEXTING IN ATTENDANCE:

*** If you have not entered your cell phone number into your CloudCME profile you will need to do so before continuing.

Step 1: Text your email address, entered in your Profile, to **(205) 236-8899**. You will receive a message that looks like the one below, paring your phone to your ACE account. This is a onetime operation.

Tip: It is recommended to save this number in your phone contacts.

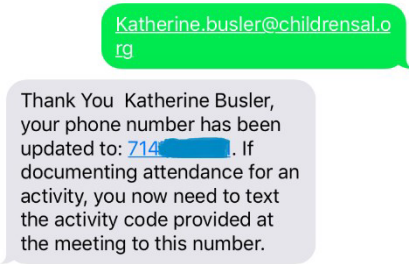

Step 2: To record your attendance to an activity, **text the Event ID** that has been provided for your activity¹. You will receive a message back that verifies your activity attendance has been recorded.

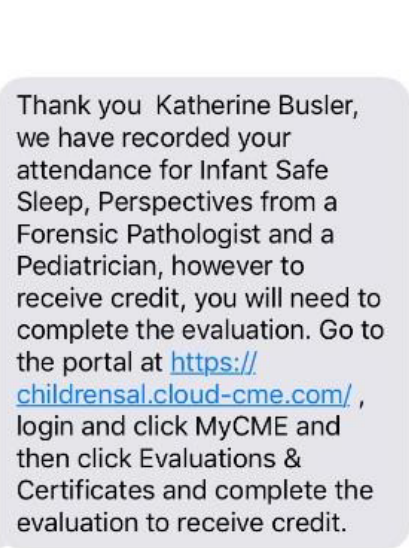

3058

You will be requested to complete an evaluation in order to receive credit. You may use the link provided **or** use the Cloud CME app to access the evaluation.

The link will require you to sign in to the Cloud CME page via your phone, the mobile app (if previously set up) will allow you more immediate access to the evaluation.

For convenience we encourage setting up the mobile app. The only requirement is an evaluation must be completed for ACE credit to be awarded.

NEXT STEP: CloudCME mobile app

The CloudCME® mobile app provides quick access to most of the CloudCME® functions. You only need to download the app and login once, and then you will be able to view content, perform ACE tasks, see listings of activities or check-in to activities from your device.

¹ You must text an SMS text message not an iMessage, if using iOS.



CloudCME™

Education

★★★★★ 3

OPEN

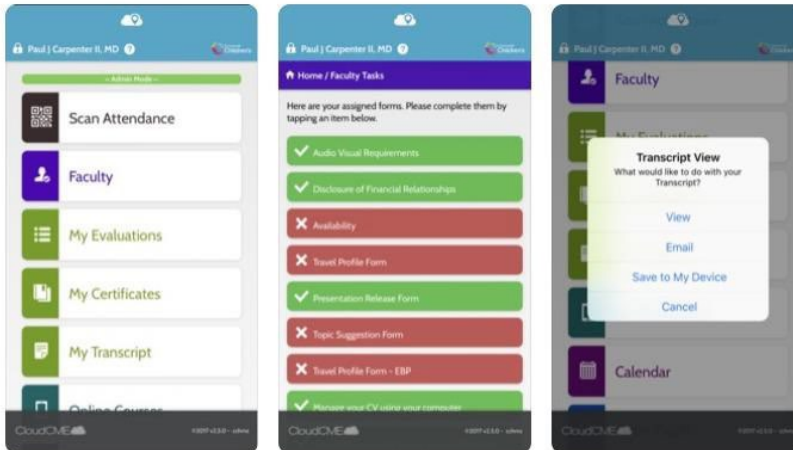

Download Links

Download the app for free from the app store and login using their organizational code **Childrensal** then enter your CloudCME® login name and password. Both institutional Single Sign-On and non-Single Sign-On CloudCME® account types are supported.

Apple iOS - <https://itunes.apple.com/us/app/cloudcme/id624053130?mt=8>

Google Android - <https://play.google.com/store/apps/details?id=com.multiweb.checkin>

Via CloudCME Mobile App

Step 1: Download App if you have not already

Step 2: Open the app, use organization code **Childrensal**

Step 3: Click the **Login or Create Account** button.

Step 4: Login using your email address and password.